

BODY BUILDER'S BOOK BULLETIN

DATE: JUNE 12, 2006
MODEL YEAR: 2005 and After
ENGINE MODEL: J05D-TA and J08E-TE
CHASSIS MODEL: UD1300~UD3300
BULLETIN NUMBER: BBB Bulletin-15

PTO INSTALLATION WITHOUT EXTERNAL ENGINE THROTTLE CONTROL

PURPOSE

To provide instructions for the PTO installation and RPM setting without the External Engine Throttle Control (EETC). If the vehicle application requires a variable speed or a fixed speed higher than 1800 RPM, an EETC must be installed. See BBB Bulletin 8 dated October 21, 2004 for EETC installation details.

DESCRIPTION

The maximum PTO high idle setting is 1800 RPM. An authorized UD Truck Dealer has the necessary computer software to program the PTO high idle setting into the Engine ECU.

RECOMMENDATIONS

PTO COMPONENT INSTALLATION

1. Install the PTO switch on the left side dash panel. The PTO switch connector is taped to the instrument harness wiring loom. See Figures 1 or 2.

UD1300, UD1400 and UD1800CS with ATM

After all components have been connected to the PTO assembly proceed to Step 6 on page 3 of this Bulletin.

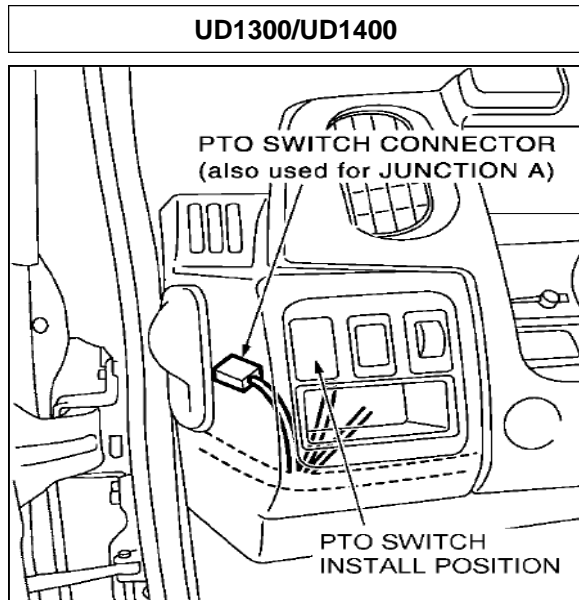

FIG. 1

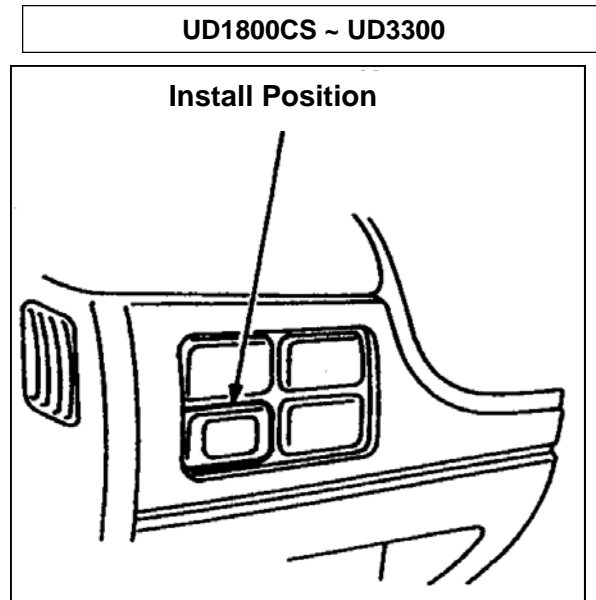

FIG. 2

PTO COMPONENT INSTALLATION cont.

2. UD1800CS ~ UD3300

Connect the JANC PTO terminals together (found on right, underside of dash panel). See Figure 3
Connect JANC A terminals together.
JANC B will not be connected.

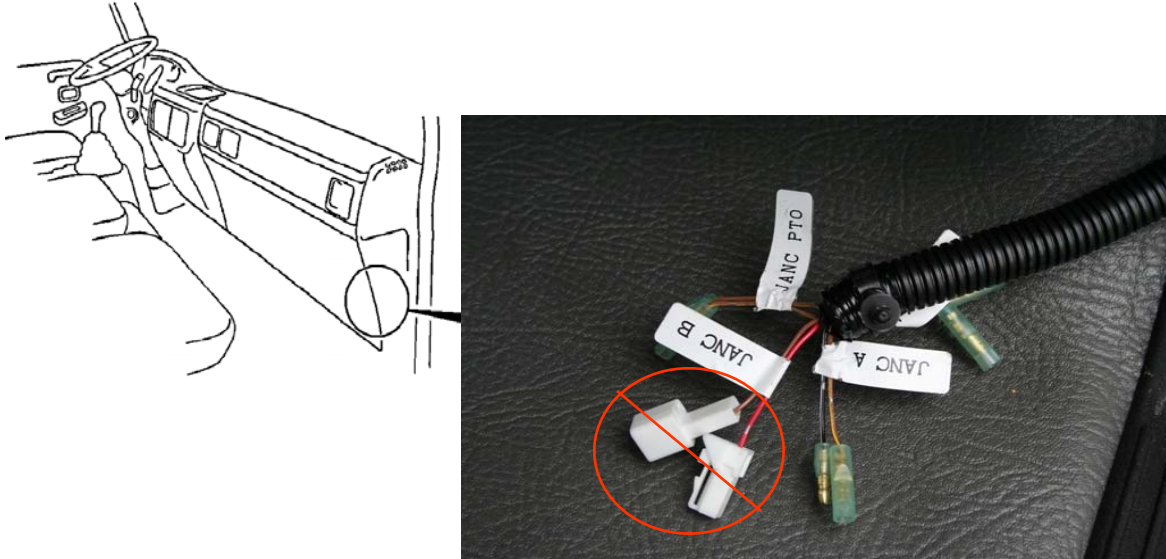

FIGURE 3

3. Install PTO Relay(s) (except UD1800CS with Aisin ATM) in the relay/junction block. Automatic Transmission equipped vehicles require two (2) relays and vehicles equipped with Manual Transmission's require one (1). See Figure 4 for the appropriate relay locations.

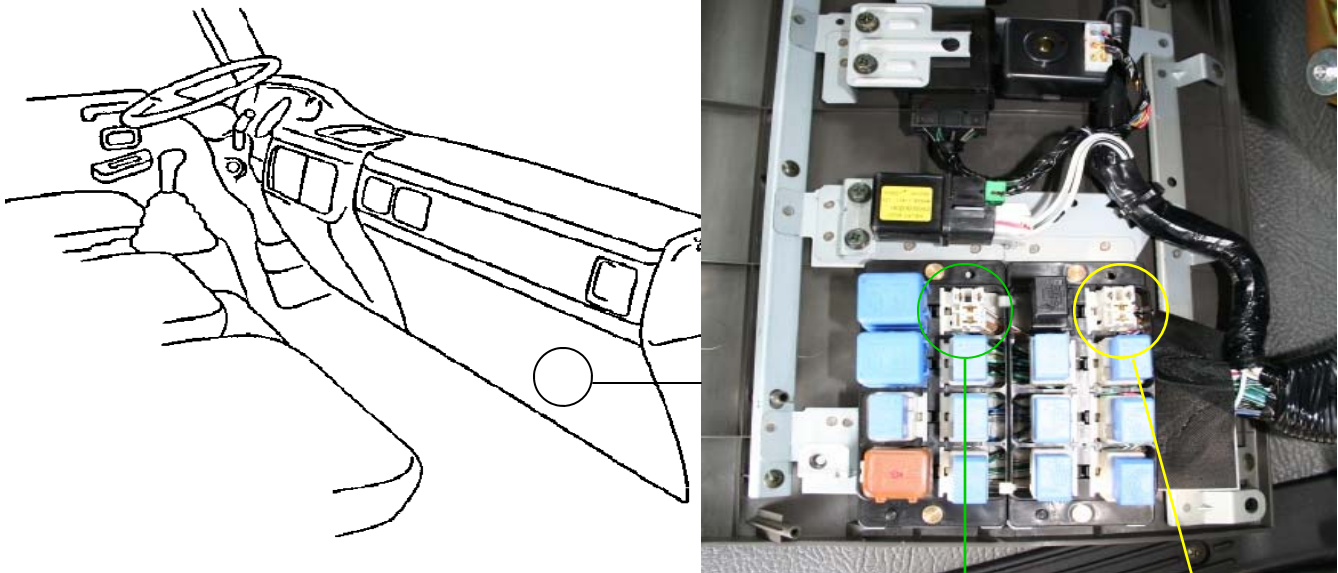

FIGURE 4

Relay installed
MTM and ATM
(except UD18CS ATM)

2nd Relay installed
only on ATM
(except UD18CS ATM)

PTO COMPONENT INSTALLATION cont.
UD1800CS ~ UD3300 :

4. Connect the PTO magnetic valve to the chassis wiring harness connector located in the left frame rail near the transmission. See Figure 5.

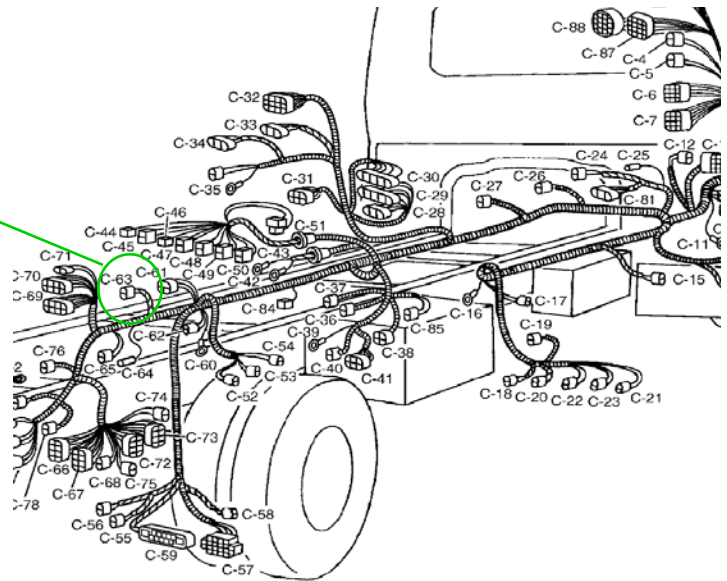

Fig. 5

5. Manual Transmission Only - Install the clutch pedal switch and related parts as shown in Figure 6. The clutch switch connector is taped to the instrument harness wiring loom.
6. All Models - The Engine ECU can now be reprogrammed for the desired high idle RPM by an Authorized UD Truck Dealer.

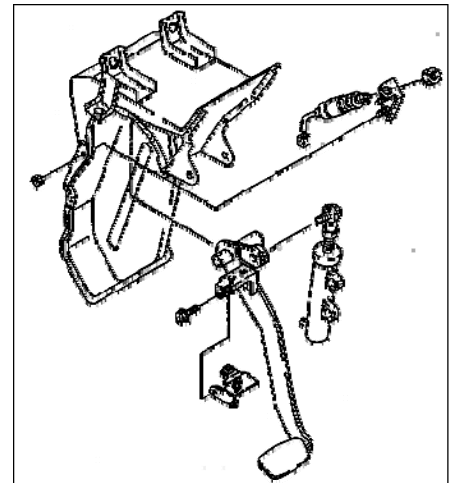

Fig. 6

WARNING: Do not connect any other electrical component or accessories to the PTO switch wiring. Damage to the engine ECU can occur if other types of electrical devices are attached to these wires.

PTO COMPONENT LOCATION AND DESCRIPTION

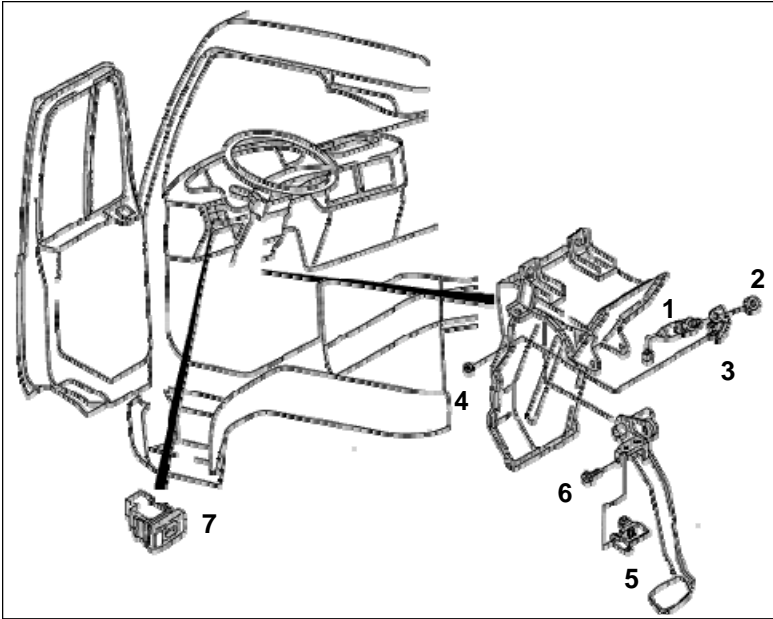

Fig. 7



Fig. 8

8

ITEM	DESCRIPTION	PART NUMBER	QTY.
1	PTO CLUTCH SWITCH	2531200Z03	1
2	NUT	MM934M12125	1
3	PTO CLUTCH SWITCH BRACKET	4647300Z00	1
4	NUT	MM6923M6	2
5	PTO CLUTCH SWITCH PLATE	2531400Z05	1
6	BOLT	083636162D	2
7	PTO DASH SWITCH	2516530Z00 (MEDIUM DUTY) 25165Z5900 (LIGHT DUTY)	1
8	PTO RELAY(S)	2523079917	1 (MTM) 2 (ATM)
AS REQUIRED	MAGNETIC VALVE (MEDIUM DUTY)	2633530Z0B	1

THE INFORMATION CONTAINED IN THIS BULLETIN SHOULD NOT BE INTERPRETED
AS THE BASIS FOR WARRANTY CLAIMS UNLESS SO DESIGNATED